

—OF—

LOT 6 OF BUBBLING SPRINGS SUBDIVISION, LOCATED IN THE NORTHWEST 1/4 OF THE SOUTHWEST 1/4, THE NORTHEAST 1/4 OF THE SOUTHWEST 1/4, AND THE NORTHWEST 1/4 OF THE SOUTHEAST 1/4 OF SECTION 34, TOWNSHIP 4 NORTH, RANGE 16 EAST OF THE FOURTH PRINCIPAL MERIDIAN, IN THE TOWN OF LAGRANGE, COUNTY OF WALWORTH AND STATE OF WISCONSIN.

SURVEY FOR: CONTOUR BUILDERS, INC.

SURVEY ADDRESS: N7488 BAY DRIVE, ELKHORN, WI 53121

BEARINGS HEREON RELATE TO THE SOUTHWESTERLY LINE OF LOT 7 OF BUBBLING SPRINGS SUBDIVISION. ASSUMED BEARING OF NORTH 50°11'00" WEST AS PLATTED.

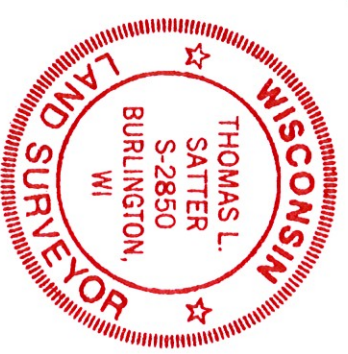
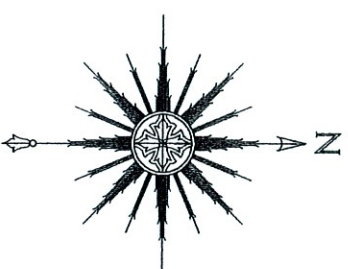

THIS IS NOT AN ORIGINAL PRINT
UNLESS THIS SEAL IS RED.

Thomas Z. Satter

THOMAS L. SATTER S-2850

REVISED: 10/2/23
AUGUST 17, 2023
DATE

072306

JOB NUMBER

"I HEREBY CERTIFY THAT I HAVE SURVEYED THE ABOVE DESCRIBED PROPERTY AND THAT THE ABOVE MAP IS A CORRECT REPRESENTATION THEREOF AND SHOWS THE SIZE AND LOCATION OF THE PROPERTY, ITS EXTERIOR BOUNDARIES, THE LOCATION OF ALL VISIBLE STRUCTURES AND DIMENSIONS OF ALL PRINCIPAL BUILDINGS THEREON, BOUNDARY FENCES, APPARENT EASEMENTS, ROADWAYS AND ENCROACHMENTS, IF ANY."

NOTE: REFER TO A CURRENT TITLE REPORT FOR EASEMENTS, RESTRICTIONS OR COVENANTS WHICH MAY AFFECT THIS PROPERTY.

LEGEND

- FOUND IRON PIPE
- ✎ FOUND MASONRY NAIL
- FOUND IRON ROD
- △ UTILITY POLE
- OVERHEAD UTILITY LINES
- () RECORDED AS

LOT 7

